

PERMANENT MAGNETIC LIFTER

SAV 531.01-M

Use :

For lifting and transporting loads up to 5000kg
Manual activation for individual charging

Features :

- Powerful Neodymium magnets ensure optimal lifting capacity even on raw parts
- SAV lifting magnets are tested individually
- The safety coefficient is at least 3
- Lifting force for round parts decreases by more than 50%
- Easy activation by rotating the lever with safety system
- Compact, robust and reliable

Example without lifting eye, with tapped holes.

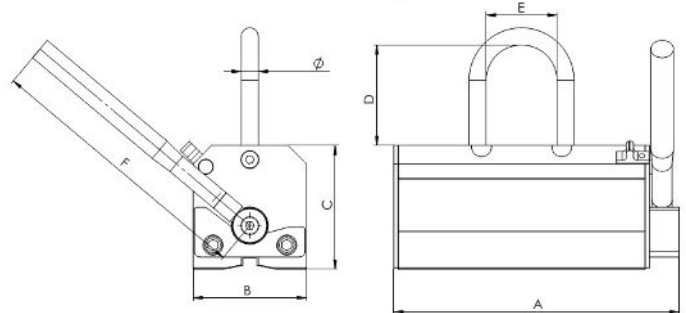

Type		100-M	300-M	600-M	1000-M	2000-M	3000-M	5000-M
Rated lifting capacity*								
- Flat piece	kg	100	300	600	1000	2000	3000	5000
- Round piece	kg	45	150	250	450	900	1350	2250
mini. Thickness	mm	2	4	6	10	15	20	30
Diameter mini/maxi	mm	30 - 100	30 - 200	40 - 250	60 - 350	150 - 400	150 - 400	150 - 400
A	mm	130	200	250	350	450	500	580
B	mm	75	80	106	145	210	255	350
C	mm	67	90	98	120	175	195	230
D	mm	50	70	70	100	110	150	150
E	mm	40	50	50	80	90	100	100
F	mm	170	195	195	320	415	450	600
Ø	mm	10	12	16	20	25	40	50
Weight	kg	4,0	9,5	18,0	41,0	112,0	190,0	400,0

*Maximum weight for S235JR steel parts with smooth contact surfaces of sufficient size and thickness. The lifting capacity varies depending on the type of material, the thickness of the part, the size and quality of the surface in contact.

Order example: Magnetic lifter SAV 531.01 - 300 M
Designation SAV N° - type

PERMANENT MAGNETIC LIFTER 250°C

SAV 531.01-MHT

Use :

For lifting and transporting loads up to 1000kg
Maximum operating temperature 250°C

Features :

- Super-powerful Samarium Cobalt magnets
- SAV lifting magnets tested individually
- The safety coefficient is at least 3
- Lifting force for round parts decreases by more than 50%
- Easy activation by rotating the lever with safety system
- Compact, robust and reliable

Type		250-MHT	500-MHT	1000-MHT
Rated lifting capacity*				
- Flat piece	kg	250	500	1000
- Round piece	kg	125	250	450
Mini. thickness	mm	4	6	10
Diameter mini/maxi	mm	30 - 200	40 - 250	60 - 350
A	mm	200	250	350
B	mm	80	106	145
C	mm	90	98	120
D	mm	70	70	100
E	mm	50	50	80
F	mm	195	195	320
Ø	mm	12	16	20
Weight	kg	9,5	18,0	41,0

*Maximum weight for S235JR steel parts with smooth contact surfaces of sufficient size and thickness. The lifting capacity varies depending on the type of material, the thickness of the part, the size and quality of the surface in contact.

Order Example: Magnetic lifter SAV 531.01 - 250 MHT
Designation SAV N° - type

